

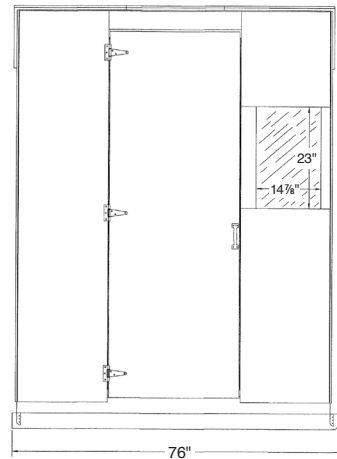

ICE FISHING hut

home.crs

DIMENSIONS



FRONT VIEW

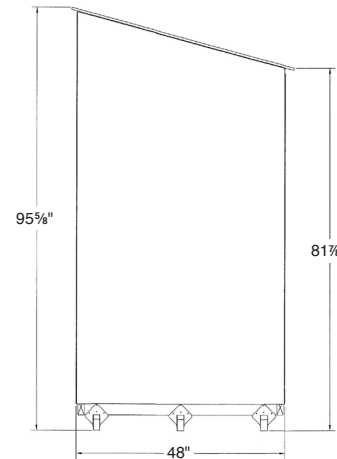

SIDE VIEW

MATERIALS LIST

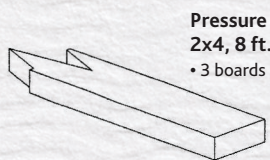

Pressure Treated
2x4, 8 ft.
• 3 boards

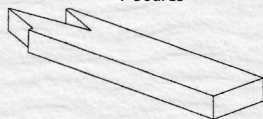

Spruce 2x4, 8 ft.
• 7 boards

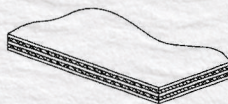

3/8"
Plywood,
4' x 8'
• 8 sheets

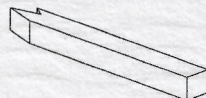

Spruce 2x2,
8 ft.
• 27 boards



Coated Deck Screws
• 1 1/2" long, 396 screws (2.5 lbs.)
• 2 1/2" long, 24 screws (0.2 lbs.)
• 3" long, 158 screws (1.75 lbs.)



#8 x 1" Wood Screws
• 60 screws

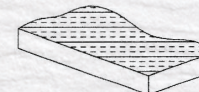

1 1/2" Rigid
Insulation,
2' x 8'
• 1 sheet



5 1/2"
Door Pull
• 1 handle

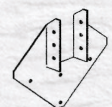

Hurricane
Ties
• 6 ties

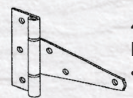

4" Tee
Hinges
• 3 hinges

ICE FISHING HUT CONSTRUCTION

1

CUTTING THE COMPONENTS

The Cutting Diagrams show how each piece of lumber is to be broken down. Refer to the Detail Drawings for cutting information regarding complex components. The components are numbered in the order they are assembled.

CUTTING DIAGRAMS

2x4 Spruce Lumber

Seven (7) boards 8' long are required for the following components: #1, 2, 3, 18, 25 and 30.

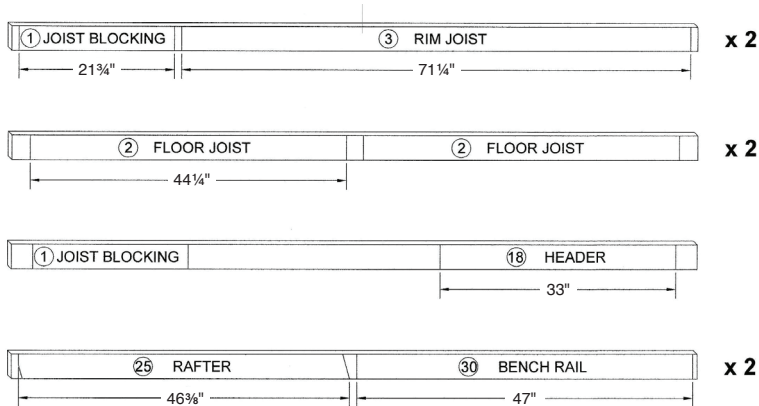

2x4 Pressure-Treated Lumber

Three (3) boards 8' long are required for component #4.



DETAIL DRAWINGS

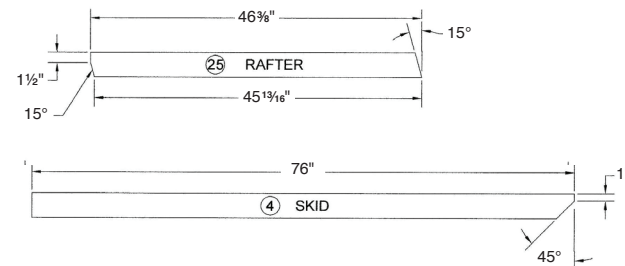

COMPONENTS LIST

#	Component Name	Quantity	#	Component Name	Quantity
①	Joist Blocking	3	⑱	Header	1
②	Floor Joist	4	⑲	Front Wall Bottom Plate	1
③	Rim Joist	2	⑳	Front Wall Top Plate	1
④	Skid	3	㉑	Front Wall Sheathing (no window)	1
⑤	Floor Sheathing	1	㉒	Front Wall Sheathing (window)	4
⑥	Bench Leg	4	㉓	Rear Wall Sheathing	2
⑦	Nailer	2	㉔	Side Wall Sheathing	2
⑧	Rear Wall Stud	4	㉕	Rafter	2
⑨	Rear Wall Bottom Plate	1	㉖	Roof Sheathing	3
⑩	Rear Wall Top Plate	1	㉗	Header Sheathing	1
⑪	Side Wall Stud	6	㉘	Bench Seat Filler	2
⑫	Side Wall Bottom Plate	2	㉙	Bench Sheathing	4
⑬	Side Wall Top Plate	2	㉚	Bench Rail	2
⑭	Bench Cleat	2	㉛	Door Stile	2
⑮	Window Blocking	4	㉜	Door Rail	3
⑯	Front Wall Stud	4	㉝	Door Sheathing	1
⑰	Trimmer Stud	2	㉞	Window Retainer	4

CUTTING DIAGRAMS (continued)

2x2 Spruce Lumber

Twenty seven (27) boards 8' long are required for the following components:

#6, 7, 8, 9, 10, 11, 12, 13, 14, 15, 16, 17, 19, 20, 28, 31 and 32.

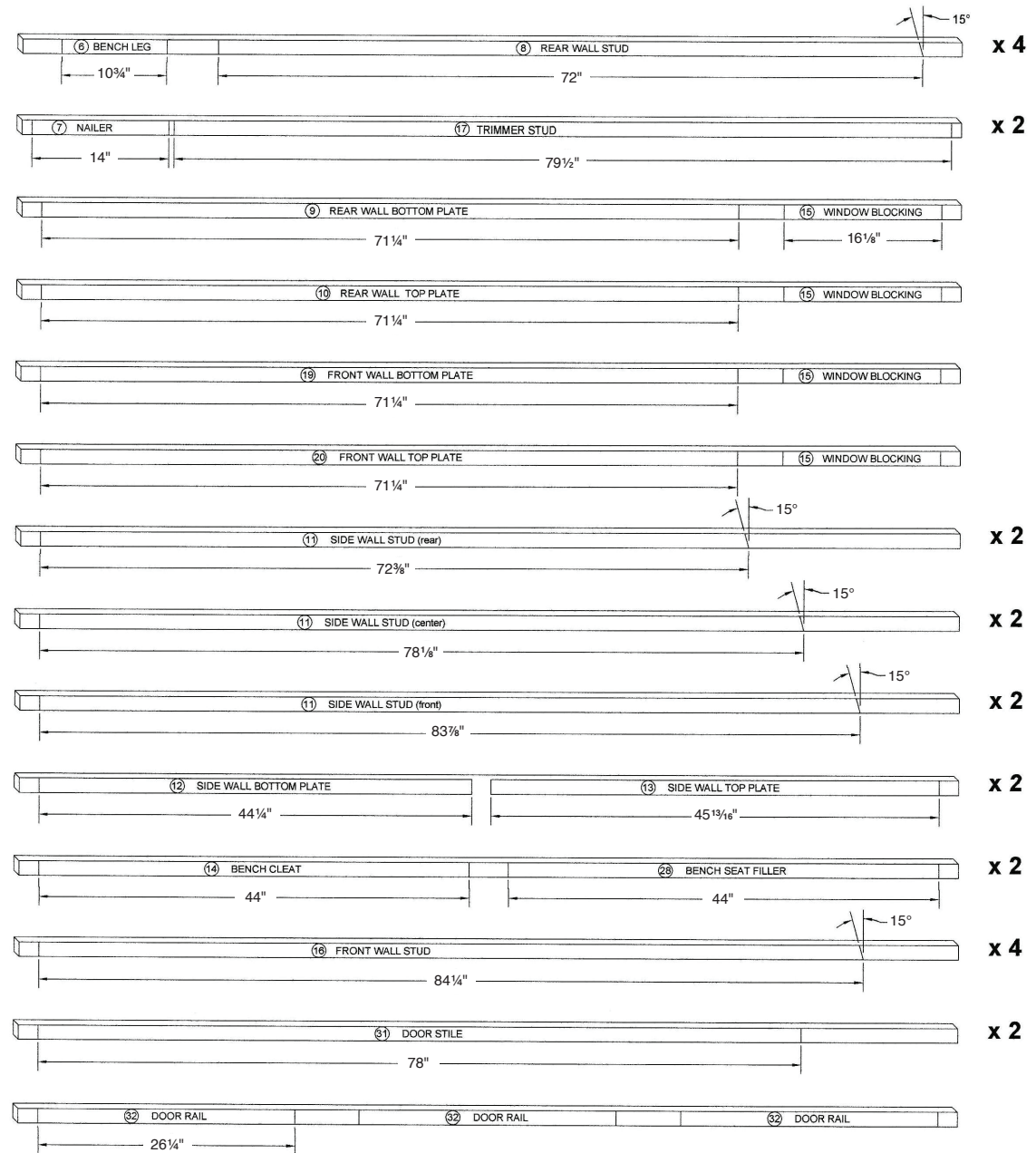

CUTTING DIAGRAMS (continued)

3/8" Plywood

Eight (8) 4' x 8' sheets are required for the following components:

#5, 21, 23, 24, 26, 27, 29, 33 and 34.

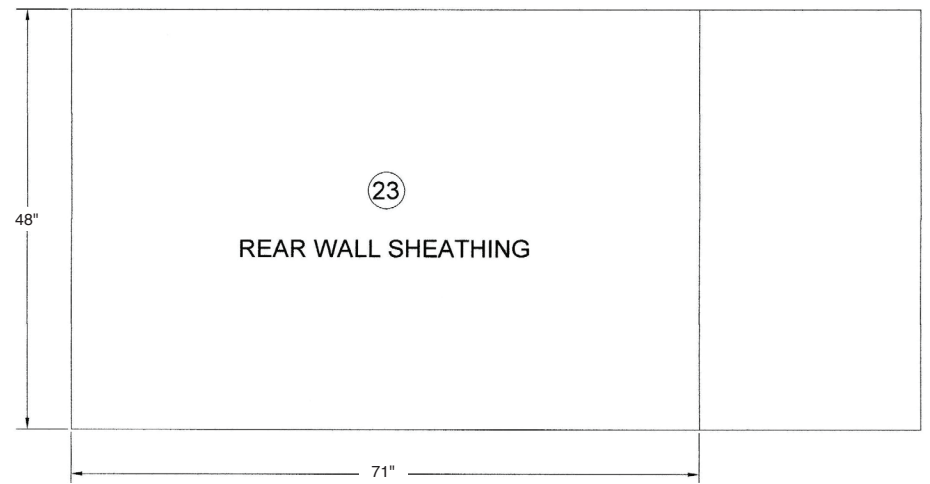
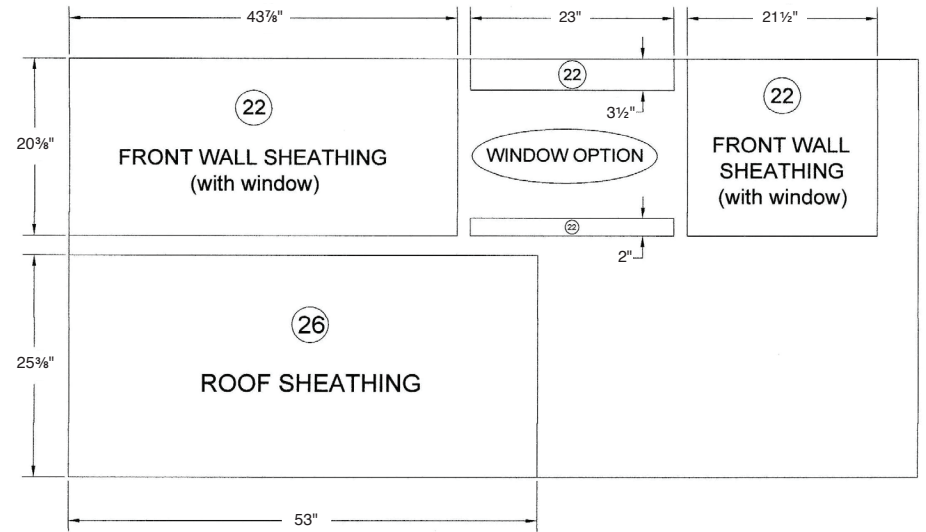
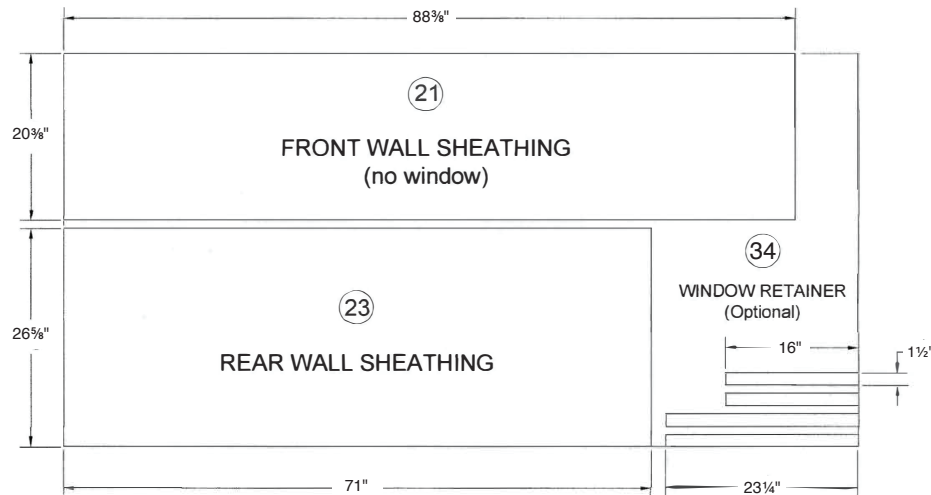
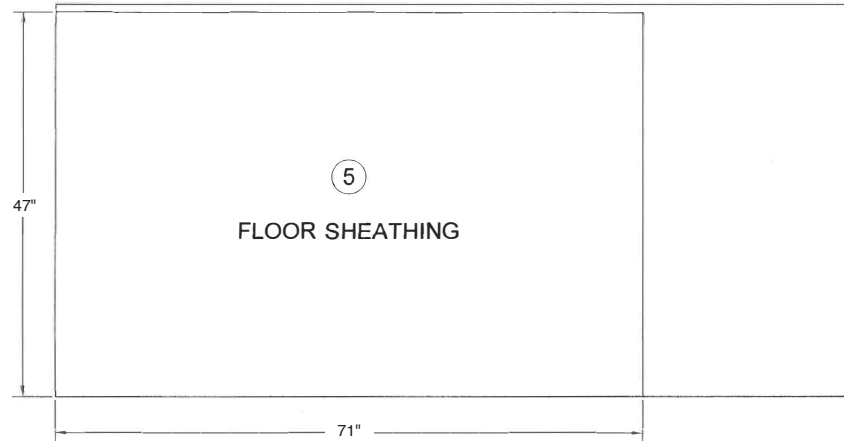

CUTTING DIAGRAMS (continued)

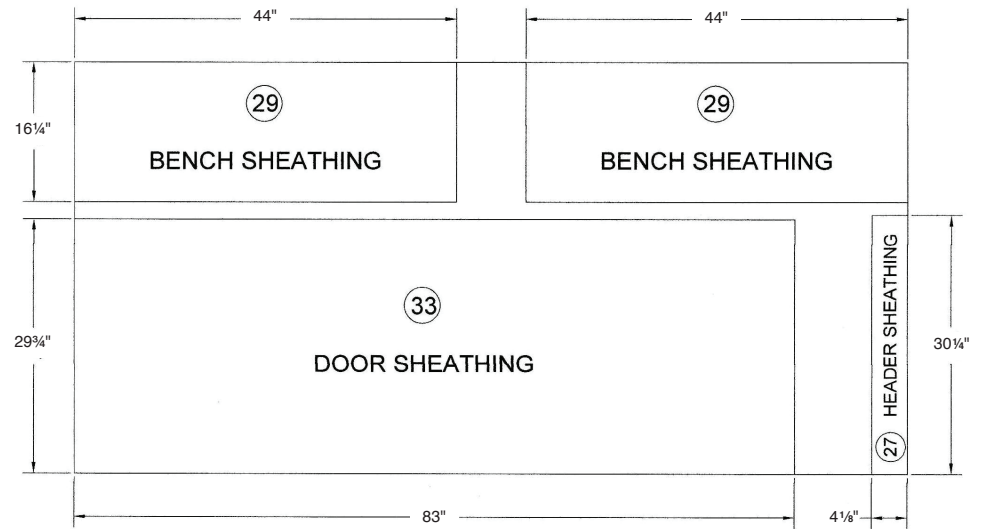
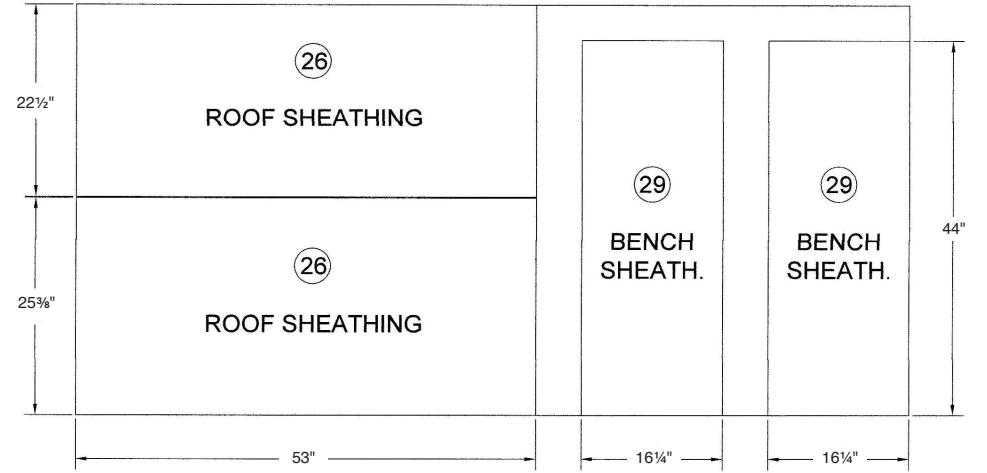
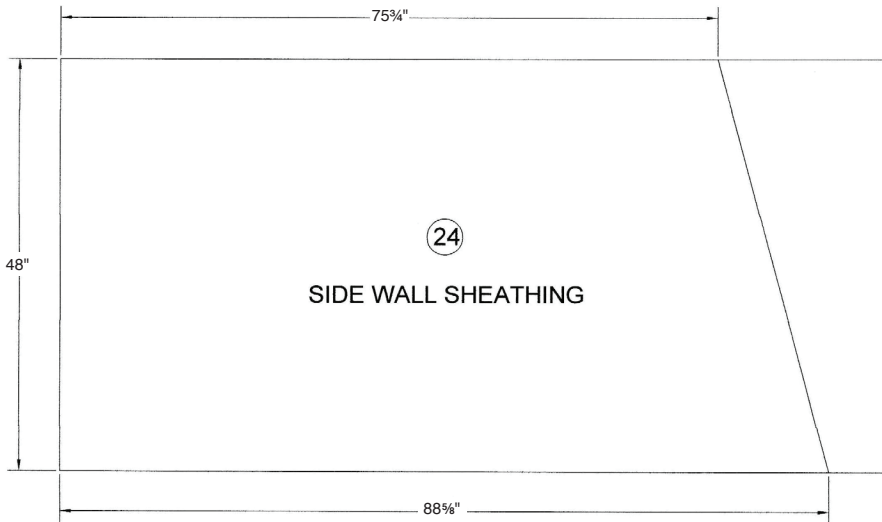
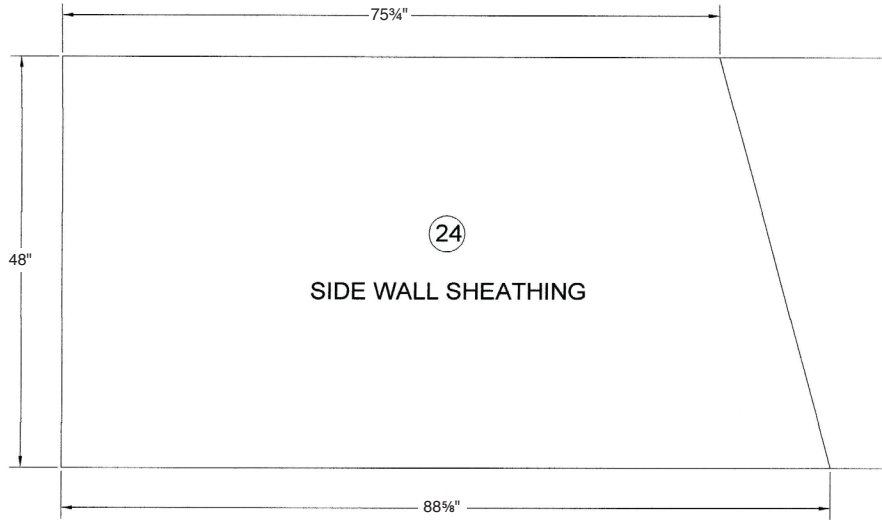

2 ICE FISHING HUT ASSEMBLY

NOTE:

• This Ice Fishing Hut is compact enough to fit in a 4' x 6½' truck box with the tailgate closed. It can be constructed with or without windows and insulation can be added to the walls, floor, and ceiling as desired.

• It is good practice to drill clearance and pilot holes before installing wood screws in narrow boards. Doing so makes it easier to align and assemble the joint, creates a stronger joint, and reduces the chance of splitting the wood.

STEP 1. JOIST AND BLOCKING ASSEMBLY

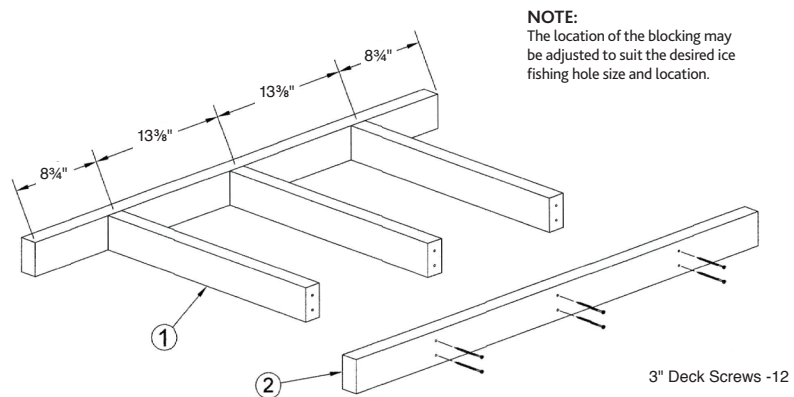

STEP 2. FLOOR FRAME ASSEMBLY

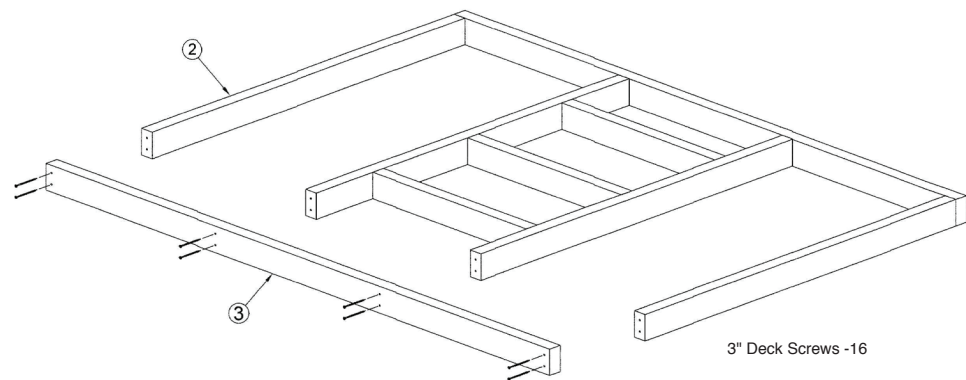

• Connect the Joist Blocking (1) to the Floor Joists (2) using 3" Deck Screws.

• Connect the Rim Joists (3) to the Floor Joists (2) using 3" Deck Screws.

ICE FISHING HUT ASSEMBLY *(continued)*

STEP 3. CONNECT THE SKIDS

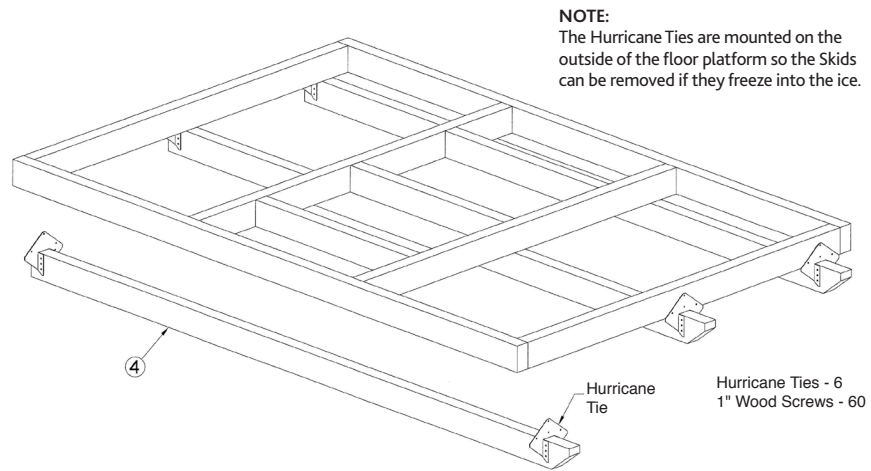

- Connect the Skids (4) to the floor frame using Hurricane Ties and 1" Wood Screws.

STEP 4. SHEATH THE FLOOR

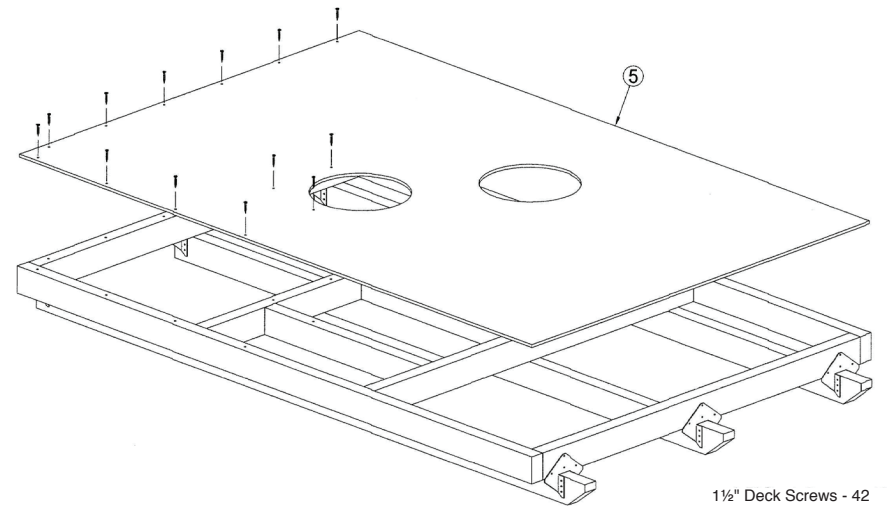

- Cut the holes and connect the Floor Sheathing (5) to the floor frame using 1 1/2" Deck Screws.

ICE FISHING HUT ASSEMBLY *(continued)*

STEP 5. FRAME THE REAR WALL

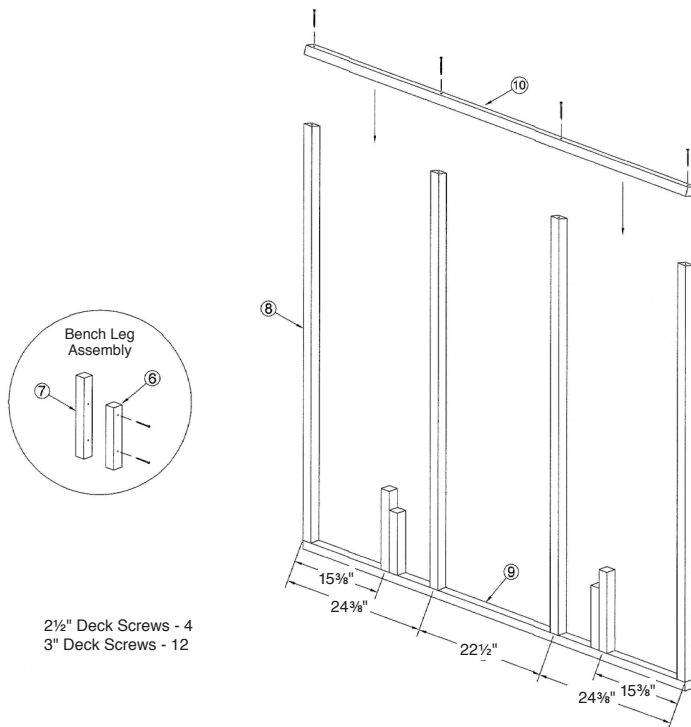

- 5.1 Connect the Bench Leg (6) to the Nailer (7) with 2½" Deck Screws to form the Bench Leg Assembly.
- 5.2 Connect the Bench Leg Assemblies and the Rear Wall Studs (8) to the Rear Wall Bottom Plate (9) and Rear Wall Top Plate (10) with 3" Deck Screws. Note the orientation of the Bench Leg Assemblies.

STEP 6. FRAME THE SIDE WALLS

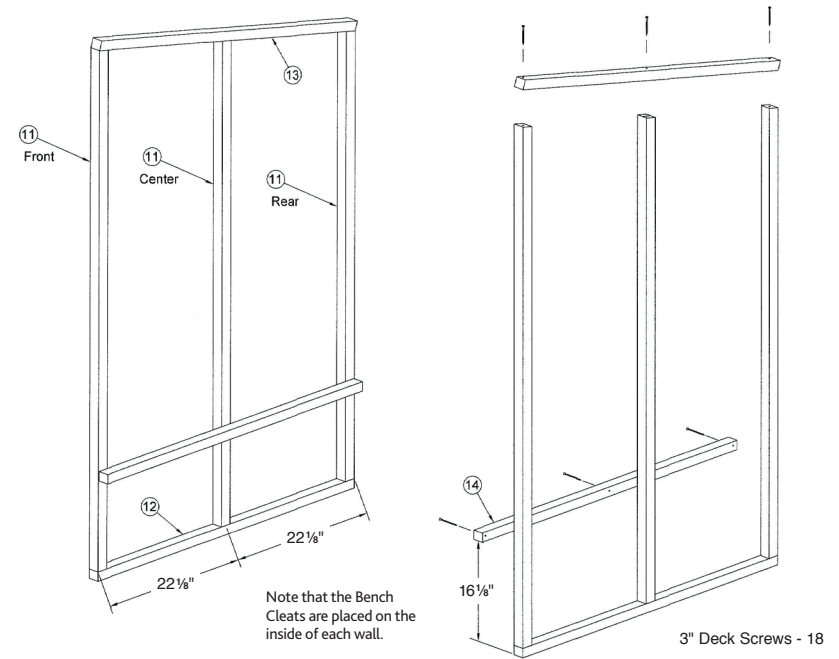

- 6.1 After confirming the stud locations, connect the Side Wall Studs (11) to the Side Wall Bottom Plate (12) and Side Wall Top Plate (13) with 3" Deck Screws.
- 6.2 Connect the Bench Cleat (14) to the studs as shown with 3" Deck Screws.

ICE FISHING HUT ASSEMBLY *(continued)*

STEP 7. FRAME THE FRONT WALL SIDE SECTIONS

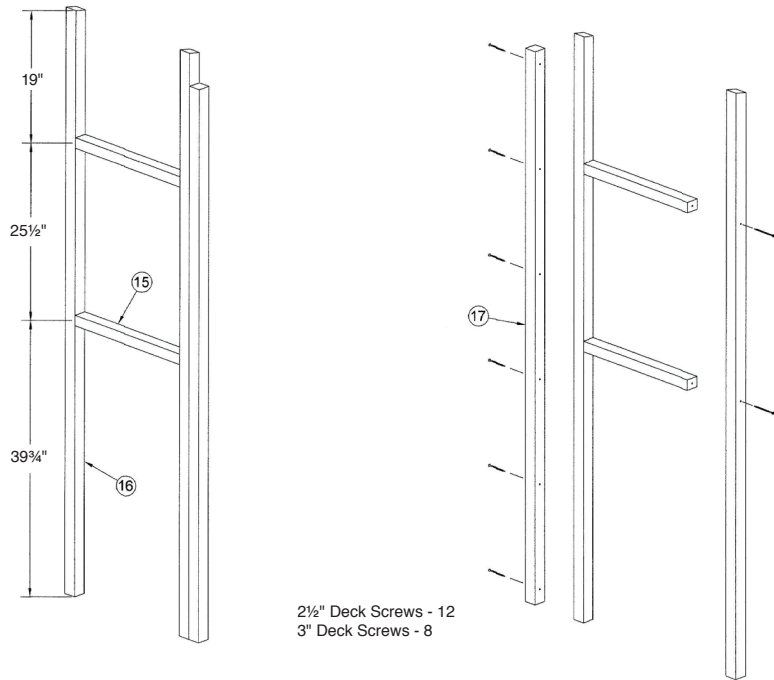

- 7.1 Position the Window Blocking (15) and Front Wall Studs (16) as shown and connect with 3" Deck Screws.
- 7.2 Connect the Trimmer Studs (17) to the Front Wall Side Sections with 2 1/2" Deck Screws.

STEP 8. FRAME THE FRONT WALL

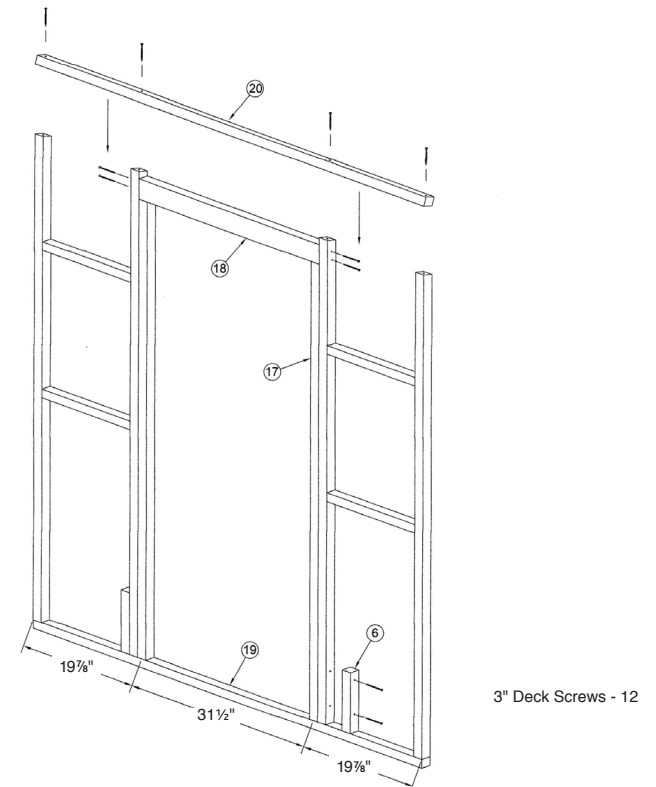

- 8.1 Position the Header (18) on top of the Trimmer Studs (17) as shown and secure with 3" Deck Screws.
- 8.2 Position the Front Wall Bottom Plate (19) and Front Wall Top Plate (20) on the ends of the studs as shown.
- 8.3 Confirm the stud locations and secure the plates to the studs with 3" Deck Screws.
- 8.4 Position the Bench Legs (6) as shown and secure with 3" Deck Screws.

ICE FISHING HUT ASSEMBLY *(continued)*

STEP 9. SHEATH THE FRONT WALL

NOTE:

- The shelter can be constructed with or without windows. Select the appropriate sheathing.
- The Front Wall sheathing should sit 1/8" below the top plate and 1/8" back of the studs.
- The sheathing should overhang the bottom plate by 1 3/8".
- DO NOT install sheathing above the door at this time.

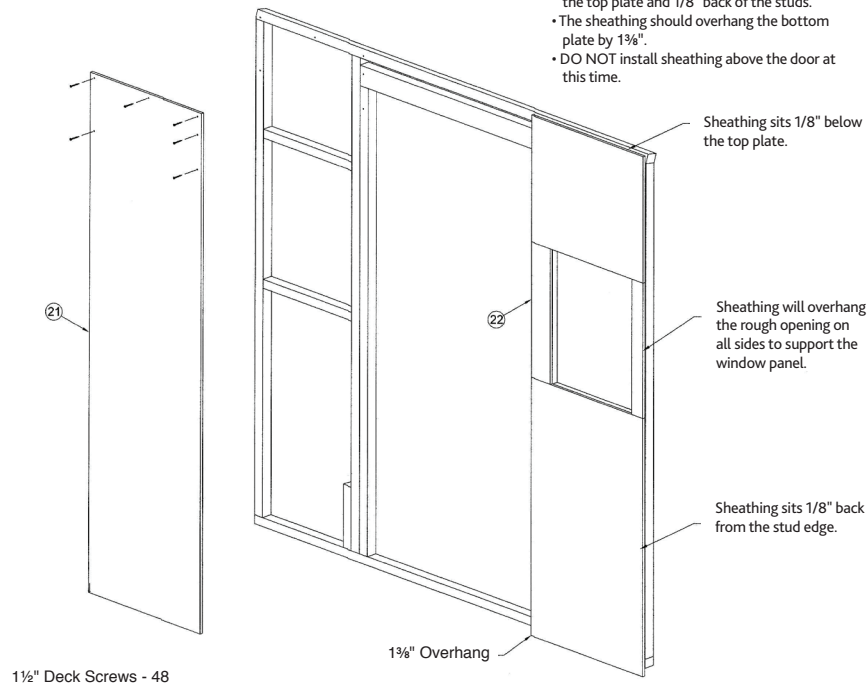

STEP 10. SHEATH THE REAR WALL

NOTE:

- The Rear Wall sheathing should sit 1/8" below the top plate and 1/8" back from the edge of the studs.
- The sheathing should overhang the bottom plate by 1 3/8".
- Be sure to drive screws through the sheathing into the bench leg assemblies.

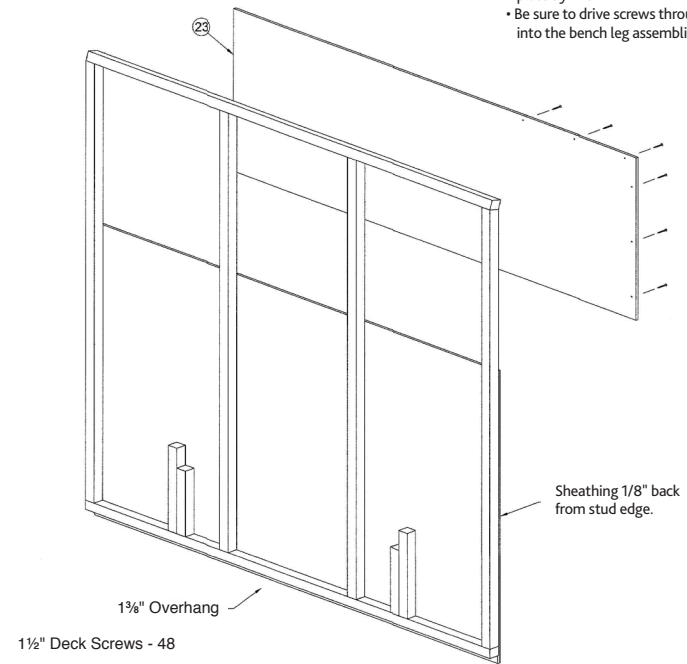

- 9.1 Secure the appropriate sheathing to the front wall with 1 1/2" Deck Screws.
- 9.2 Use Front Wall Sheathing (21) for walls with no windows and Front Wall Sheathing (22) for walls with windows.

- Secure the Rear Wall Sheathing (23) to the rear wall framing with 1 1/2" Deck Screws.

ICE FISHING HUT ASSEMBLY *(continued)*

STEP 11. SHEATH THE SIDE WALLS



NOTE:

- The Side Wall sheathing should sit 1/8" below the top plate.
- The sheathing should overhang the bottom plate and studs by 1 3/4".

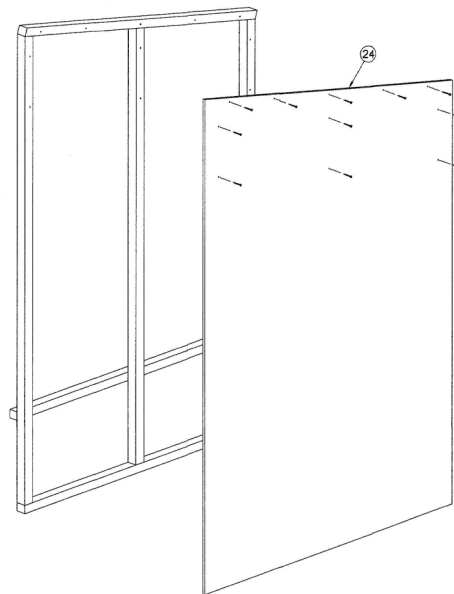

STEP 12. STAND THE WALLS

- #### NOTE:
- A helper and/or adequate temporary bracing is required to erect the walls safely.

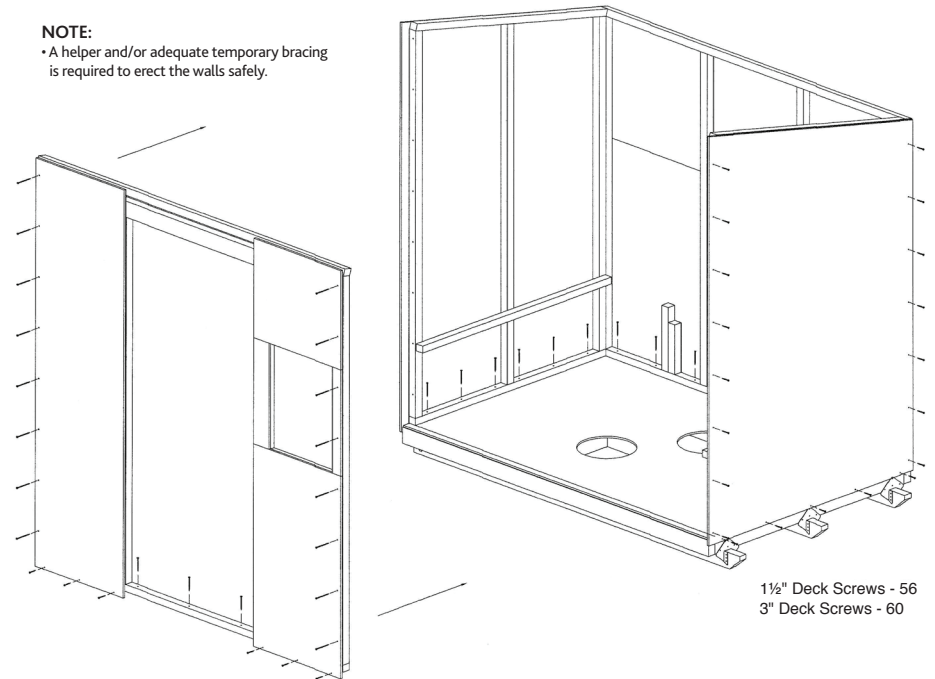

- Secure the Side Wall Sheathing (24) to the side wall framing with 1 1/2" Deck Screws.

- 12.1 Stand the walls on the floor platform and secure with 3" Deck Screws driven through the bottom plates into the floor joists.
- 12.2 Connect the corner studs with 3" Deck Screws driven through the front and rear walls.
- 12.3 Drive 1 1/2" Deck Screws through the sheathing overhangs into the floor joists and studs.

ICE FISHING HUT ASSEMBLY *(continued)*

STEP 13. SET THE RAFTERS

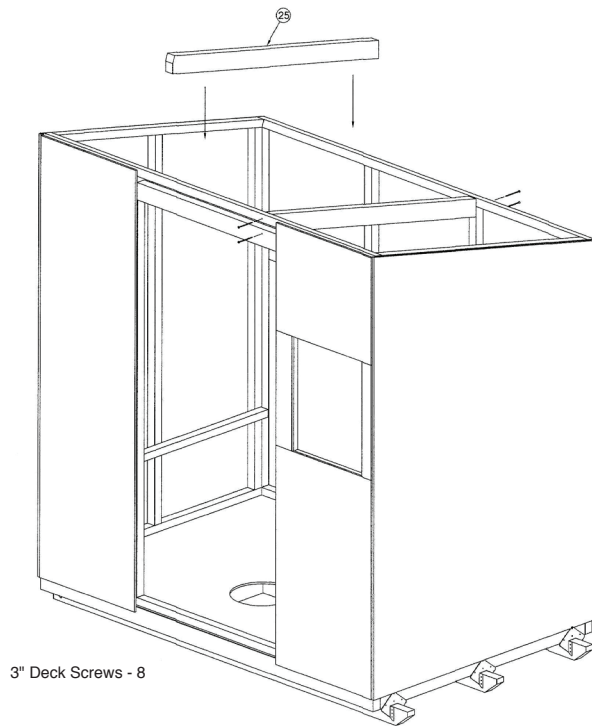

- 13.1 Set the Rafters (25) between the Rear Wall Studs and the Front Top Plate and Header.
- 13.2 Secure the rafters with 3" Deck Screws.

STEP 14. SHEATH THE ROOF

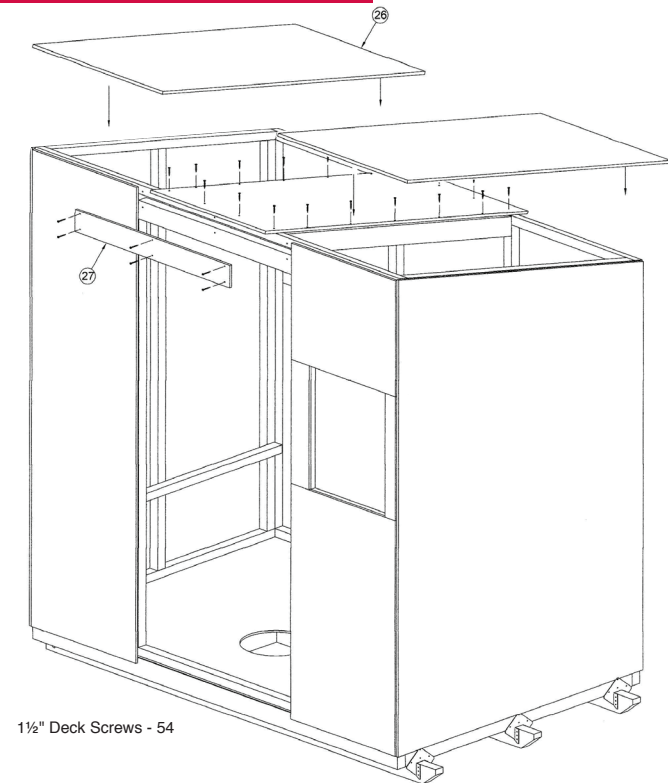

- 14.1 Beginning with the centre section, secure the Roof Sheathing (26) with 1½" Deck Screws.
- 14.2 Install the Header Sheathing (27) above the door with 1½" Deck Screws.

ICE FISHING HUT ASSEMBLY *(continued)*

STEP 15. ASSEMBLE THE BENCH

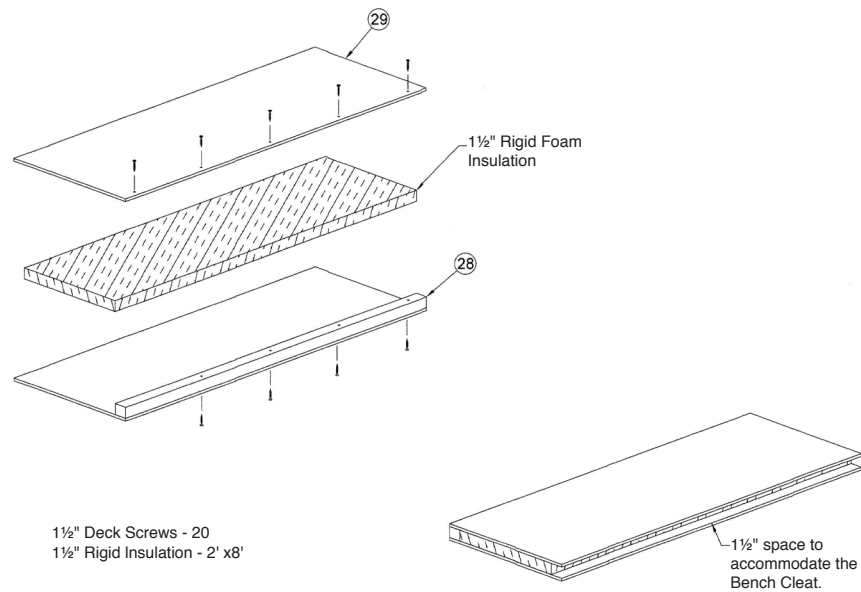

- 15.1 Connect the Bench Seat Filler (28) to the Bench Sheathing (29) with 1 1/2" Deck Screws.
- 15.2 Fill the space between the sheathing with Rigid Foam Insulation, leaving a 1 1/2" space on the back edge of the seat.

STEP 16. INSTALL THE BENCH SEATS

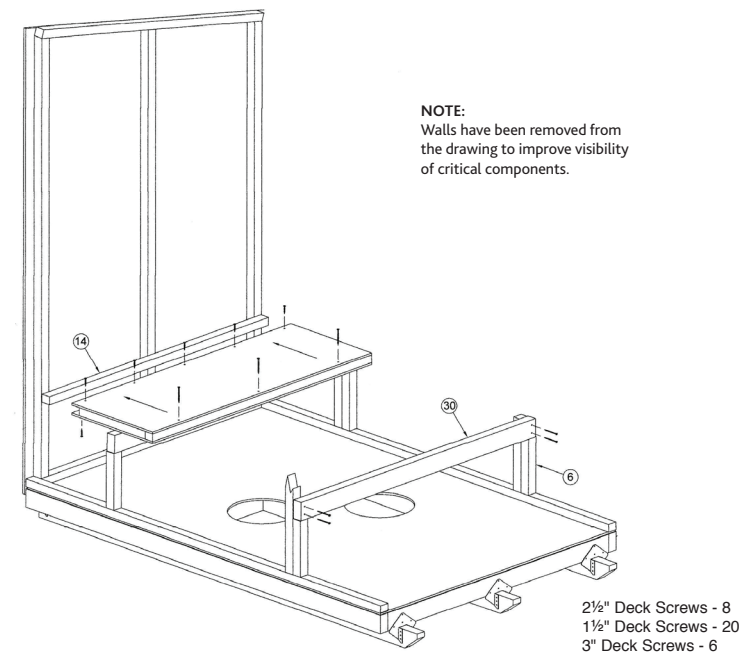

- 16.1 Position the Bench Rail (30) on the Bench Legs (6) as shown and connect with 2 1/2" Deck Screws.
- 16.2 Place the bench seat assembly on the Bench Rail and slide it back over the Bench Cleat (14).
- 16.3 Secure the Bench Sheathing to the Cleat from the top and bottom with 1 1/2" Deck Screws.
- 16.4 Secure the front edge of the bench seat assembly to the Bench Rail with 3" Deck Screws.

ICE FISHING HUT ASSEMBLY *(continued)*

STEP 17. ASSEMBLE THE DOOR

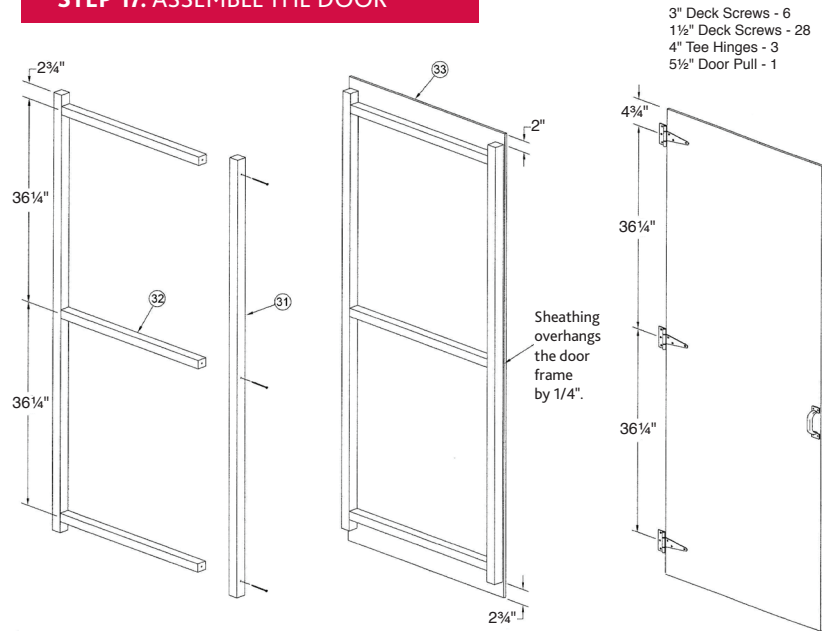

- 17.1 Position the Door Stiles (31) and Door Rails (32) as shown and connect with 3" Deck Screws.
- 17.2 Attach the Door Sheathing (33) to the door frame as indicated with 1 1/2" Deck Screws.
- 17.3 Install the Tee Hinge in line with the Door Rails.
- 17.4 Install the Door Handle as desired.

STEP 18. SET THE DOOR AND WINDOW

NOTE:

- The window panel was not included in the materials list at the start of these assembly instructions.
- A variety of materials can be used for this optional component, including clear acrylic or polycarbonate panels.
- A detail drawing of the window assembly, including dimensions, is shown below.

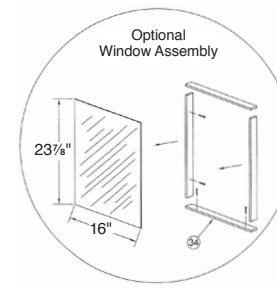

- 18.1 Secure the hinges to the Trimmer Stud.
- 18.2 Working from the inside of the shelter, place the Window Panel in the rough opening.
- 18.3 Secure the panel by attaching the Window Retainers (34) to the studs and blocking around the rough opening with 1 1/2" Deck Screws.
- 18.4 If desired, wall, joist and rafter cavities can now be filled with insulation.

In addition to the Terms of Use found at www.fcl.crs/contact-us/privacy-terms, you are responsible for any applicable code approval or permits associated with the construction and use of this plan. Check with a building-code official or a building expert to make sure that the materials and construction methods shown meet local codes and conditions and are suitable to your situation. It is the responsibility of the builder to ensure the proper tools, measurements, cuts and building techniques are used in the construction of this plan. CO-OP® assumes no responsibility for the incorrect use of this information. Please ensure the manufacturer's instructions are followed in the use of all tools and materials and heed all recommended safety guidelines.

©CO-OP and design trademark are registered trademarks of Federated Co-operatives Limited, Saskatoon S7K 3M9